

Add a New Email Account Apple

1. Navigate to your **Settings** app.
2. Scroll down until you find **Mail**.

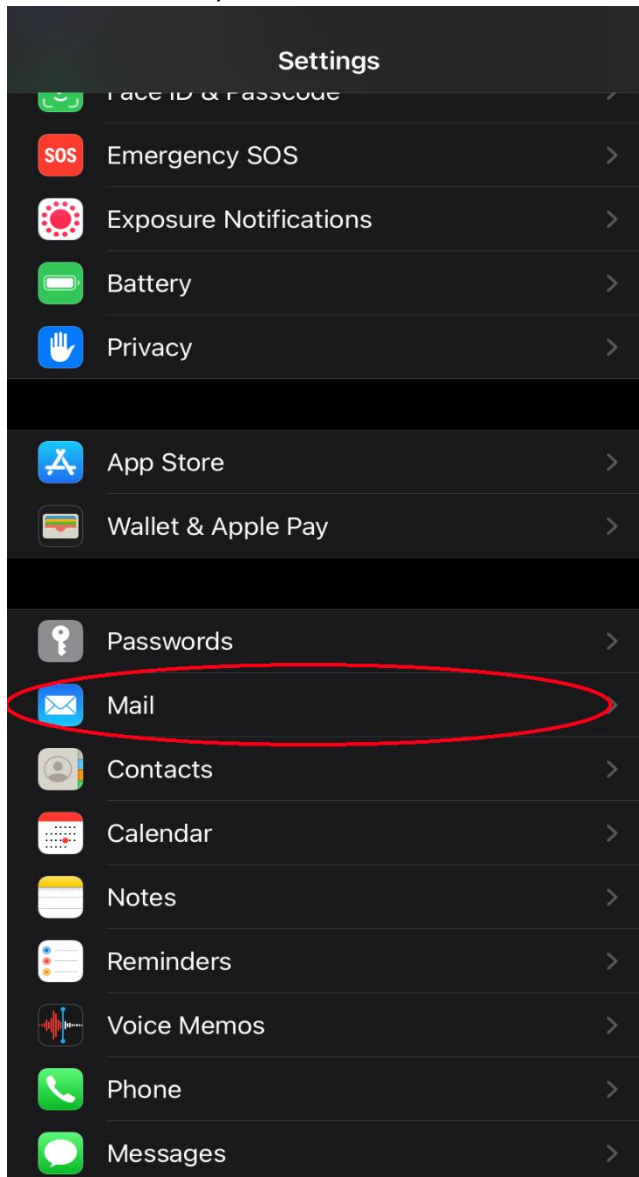

3. When in **Mail** settings, navigate to **Accounts**.

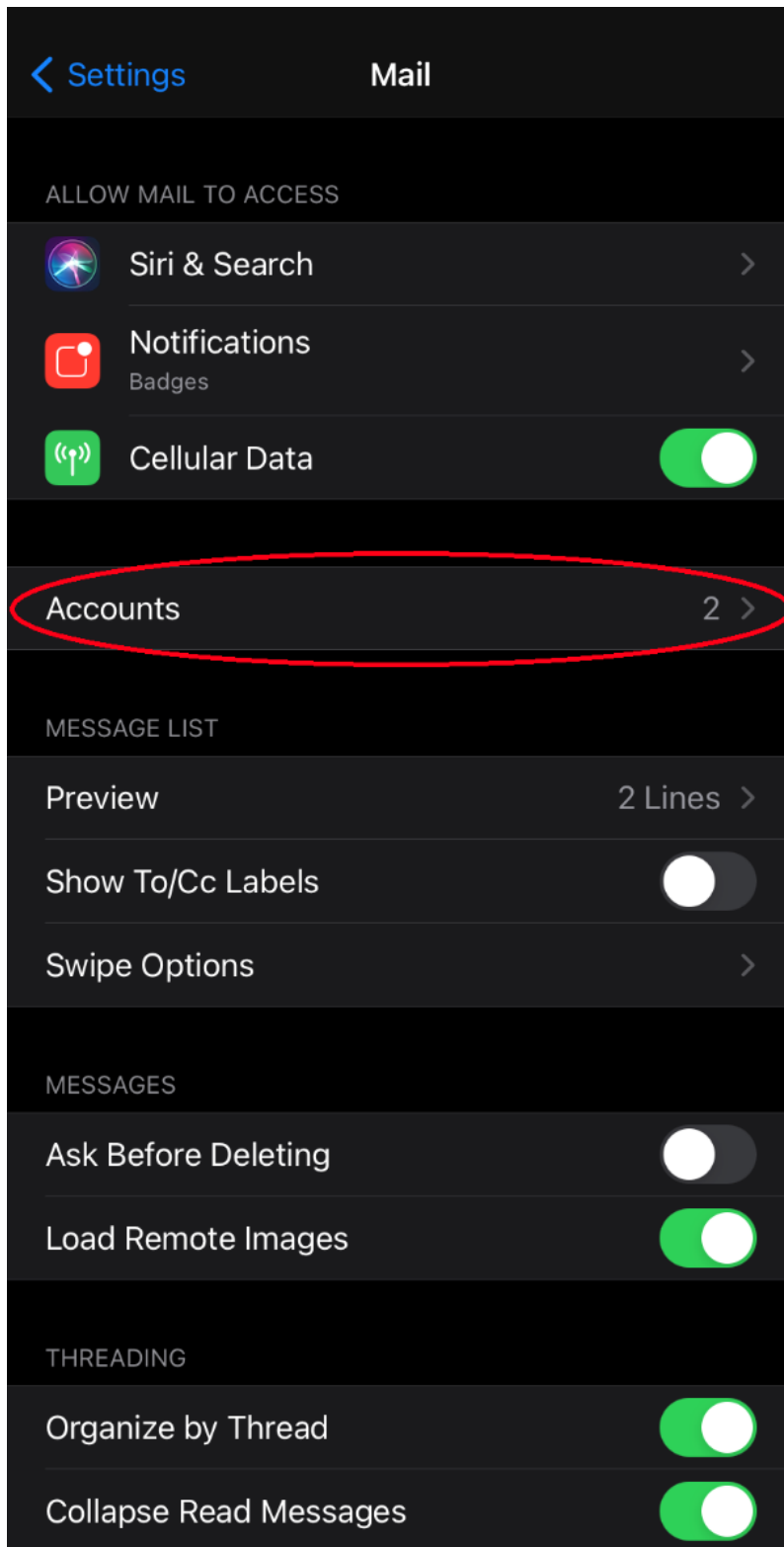

4. Select **Add Account**.

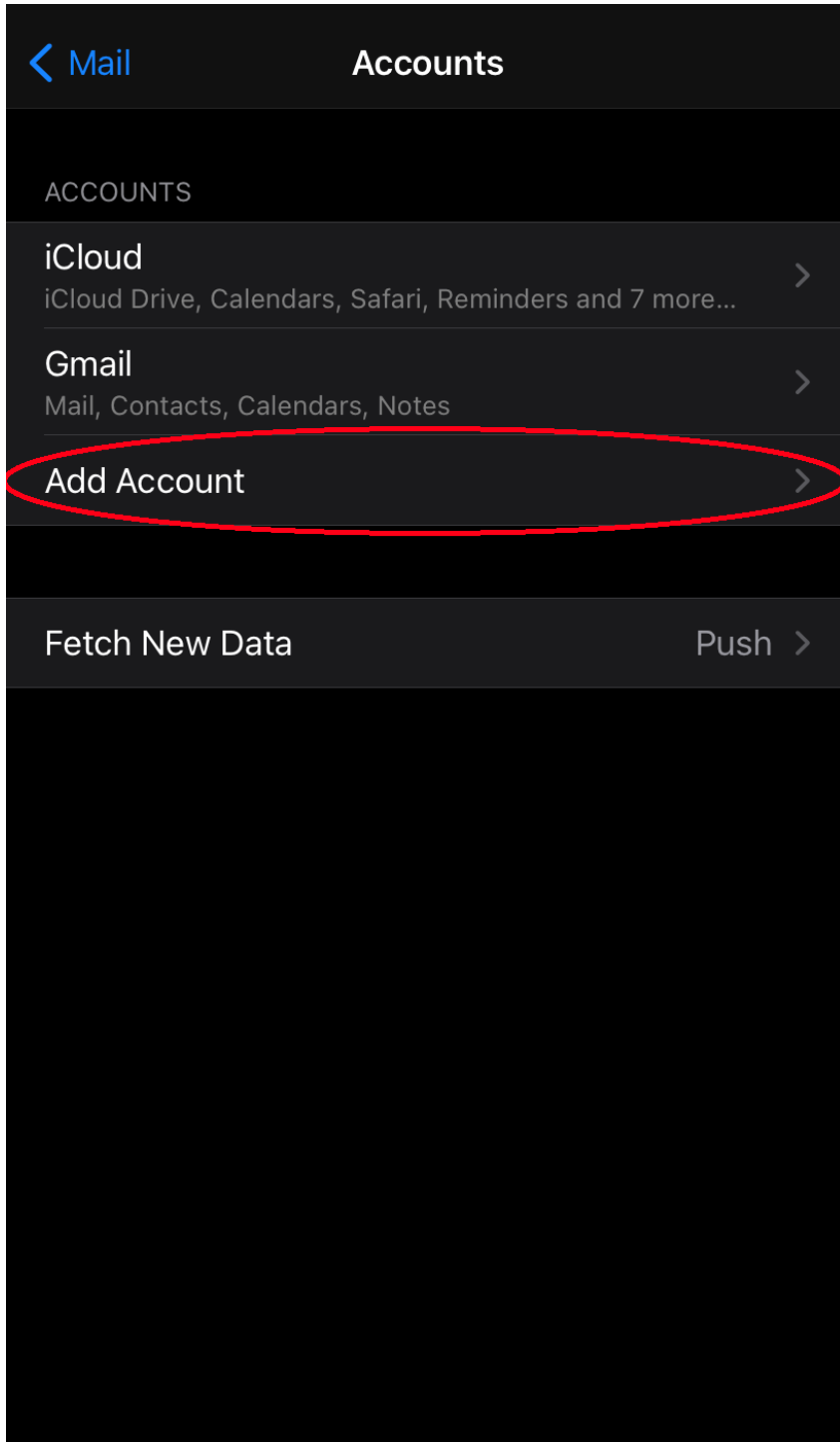

5. Select **Other**.

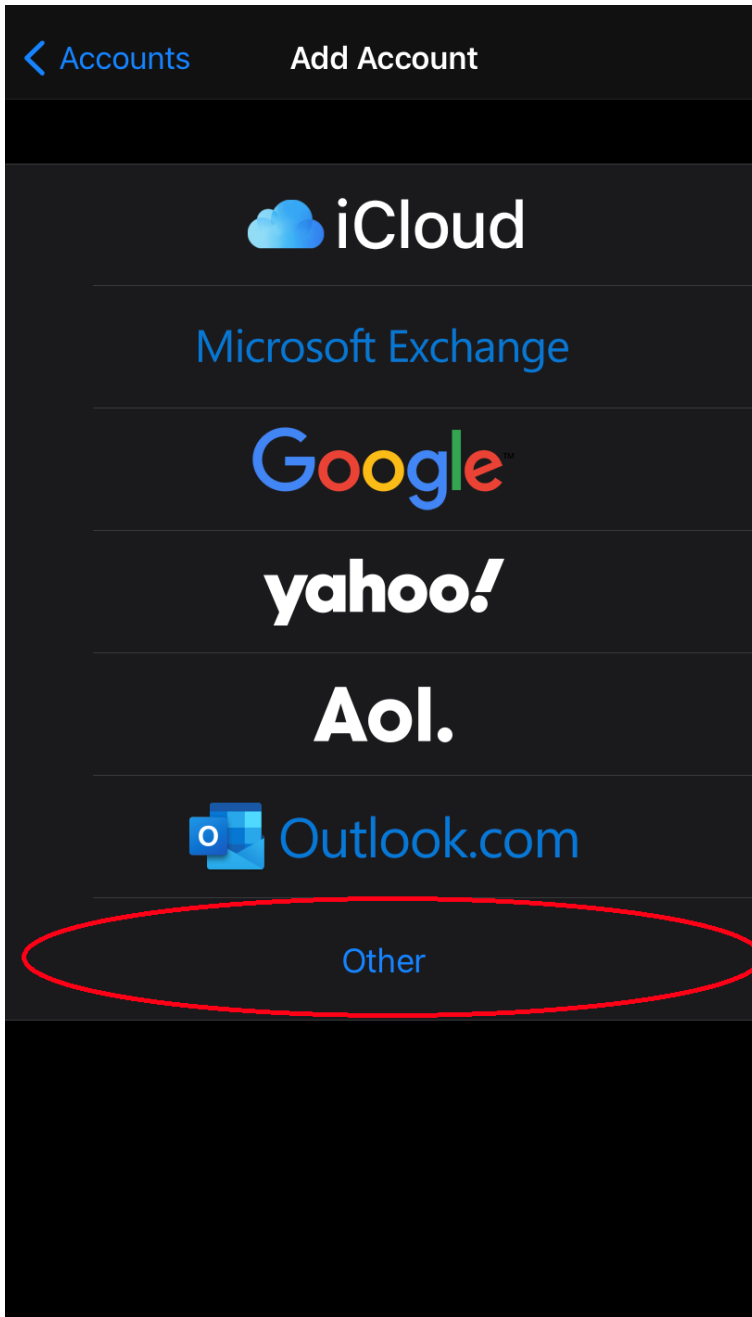

6. Fill out with your information i.e.: Name, Email, Password. (see pictures for reference).

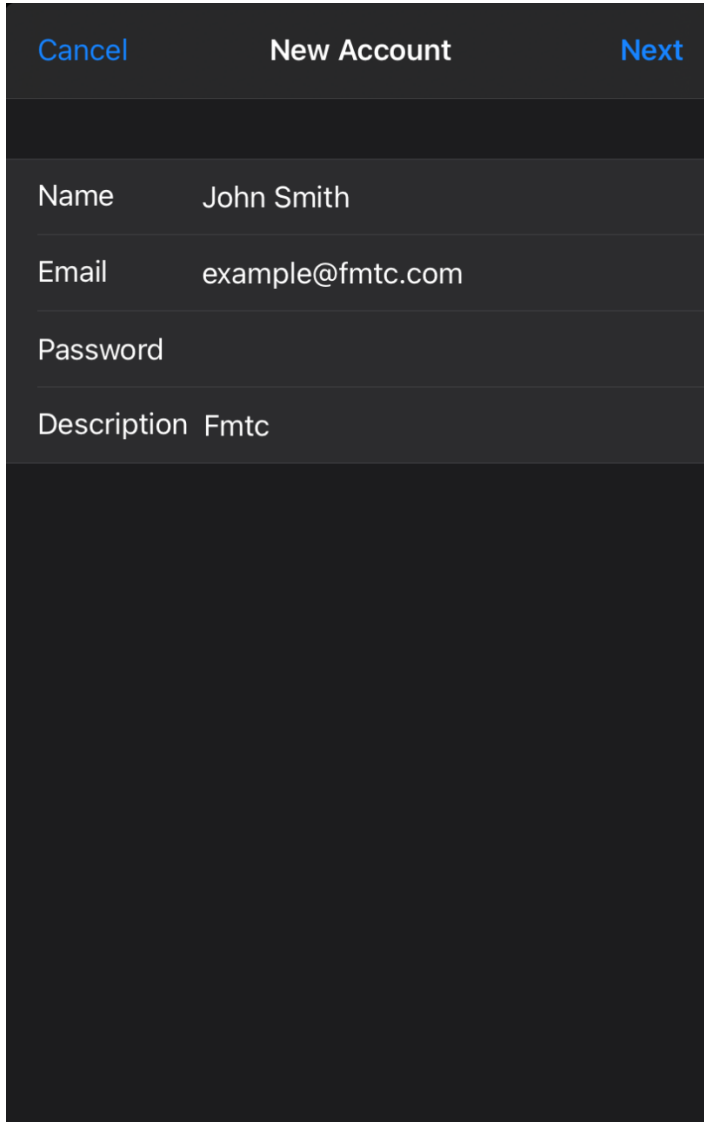

The image shows a dark-themed mobile application screen for creating a new account. At the top, there are three buttons: 'Cancel' on the left, 'New Account' in the center, and 'Next' on the right. Below the buttons, there are four input fields, each with a label on the left and a text entry on the right. The fields are: 'Name' with the value 'John Smith', 'Email' with the value 'example@fmtc.com', 'Password' which is currently empty, and 'Description' with the value 'Fmtc'. The bottom portion of the screen is a solid dark grey area.

Cancel	New Account	Next
Name	John Smith	
Email	example@fmtc.com	
Password		
Description	Fmtc	

7. Select **Next**

8. Select **IMAP**, then fill out accordingly with your information and the following **Host Name**.

The screenshot shows an email account setup interface. At the top, there are three buttons: 'Cancel' on the left, 'New Account' in the center, and 'Next' on the right. Below these buttons are two radio buttons for selecting the email protocol: 'IMAP' (which is selected) and 'POP'. The form is divided into several sections. The first section contains fields for 'Name' (John Smith), 'Email' (example@fmtc.com), and 'Description' (Fmtc). The second section is titled 'INCOMING MAIL SERVER' and contains fields for 'Host Name' (mail.fmtc.com), 'User Name' (example@fmtc.com), and 'Password'. The third section is titled 'OUTGOING MAIL SERVER' and contains fields for 'Host Name' (smtp.fmtc.com), 'User Name' (example@fmtc.com), and 'Password'.

Select **Next**.